



3201 GULF BLVD. SUITE 202  
 VEROBEECH, FL 33408  
 (561) 961-2625  
 info@barrancoarchitecture.com  
 www.barrancoarchitecture.com

THIS DOCUMENT IS THE PROPERTY OF BARRANCO ARCHITECTURE AND DESIGN STUDIOS. IT IS TO BE USED ONLY FOR THE PROJECT AND SITE SPECIFICALLY IDENTIFIED HEREIN. NO PART OF THIS DOCUMENT IS TO BE REPRODUCED OR TRANSMITTED IN ANY FORM OR BY ANY MEANS, ELECTRONIC OR MECHANICAL, WITHOUT THE WRITTEN PERMISSION OF BARRANCO ARCHITECTURE AND DESIGN STUDIOS.

NO.	DATE	DESCRIPTION
1	02/14/08	CONCEPT
2		REVISED
3		REVISED

**SITE PLAN FOR:**  
**SHOPPES @ VERO BEACH**  
 VERO BEACH, FLORIDA

DATE: 02/14/08  
 DRAWN BY: CRYSTAL COOK  
 CHECKED BY: CRYSTAL COOK  
 SCALE: 1" = 60'

**SP-1.0**

**SITE PLAN**  
 DATE: 02/14/08  
 SCALE: 1" = 60'

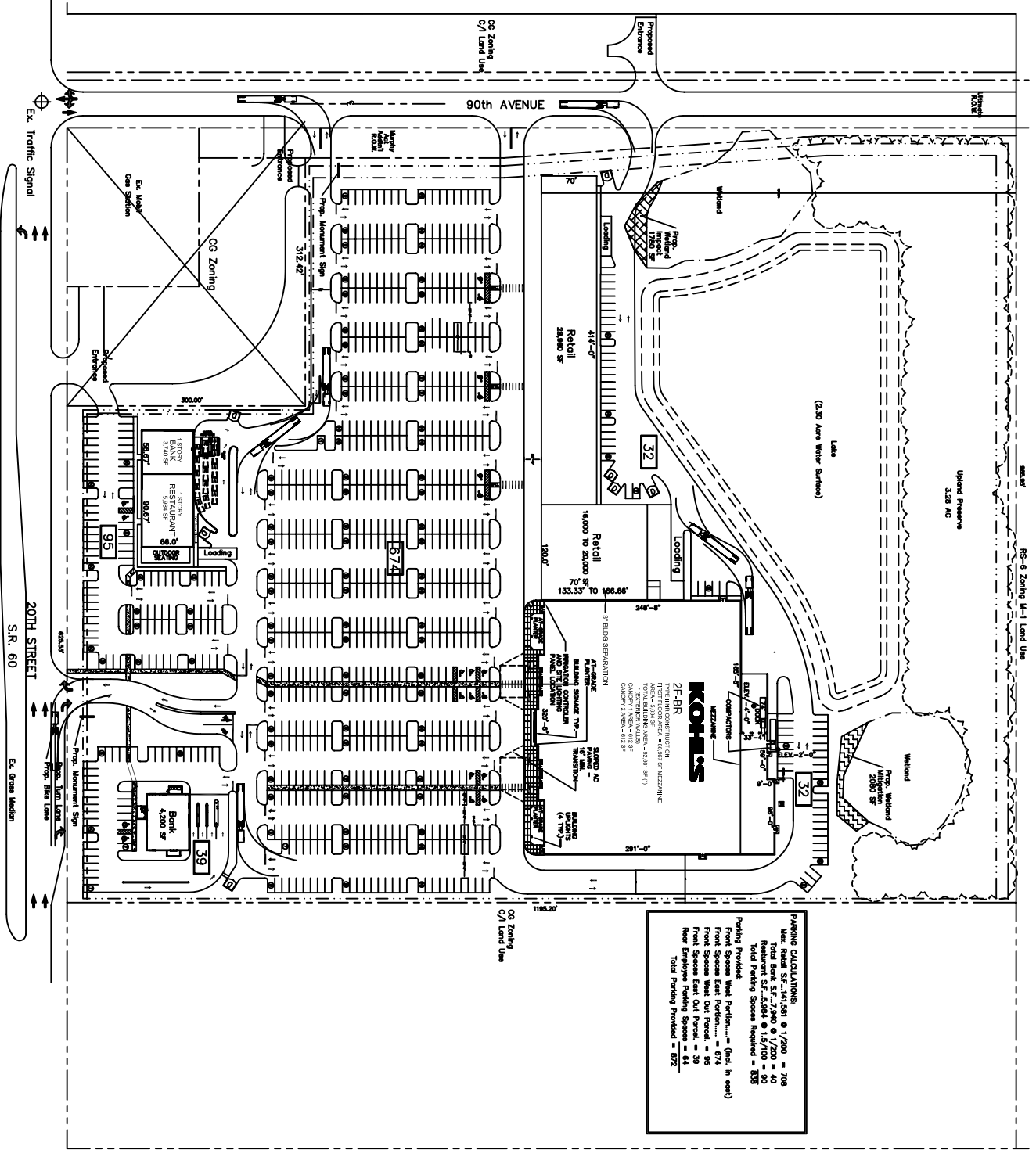

**PARKING CALCULATIONS:**  
 Main Retail S.F. = 14,150 @ 1/200 = 708  
 Total Bank S.F. = 7,940 @ 1/200 = 40  
 Restaurant S.F. = 5,584 @ 1.5/100 = 90  
 Total Parking Spaces Required = 838  
 Total Parking Spaces Provided = 872

**Parking Provided:**  
 Front Spaces West Portion = (incl. h eat) = 94  
 Front Spaces West Portion = 94  
 Front Spaces East Portion = 39  
 Rear Employee Parking Spaces = 64  
 Total Parking Provided = 872

**SITE DATA**  
 SCALE: 1" = 60'

GENERAL	AREA	PERCENTAGE
GEOSIS SITE AREA	1,029,703 SQ. FT.	23.56 ACRES
GENERAL LAYOUT	448,872 SQ. FT.	10.23 ACRES
VERO BEACH LAYOUT	338,872 SQ. FT.	7.70 ACRES
LANDSCAPE LAYOUT	59,227 SQ. FT.	2.82 ACRES
LANDSCAPE LAYOUT	143,330 SQ. FT.	3.27 ACRES